

Extent of Reclamation at Central Waterfront

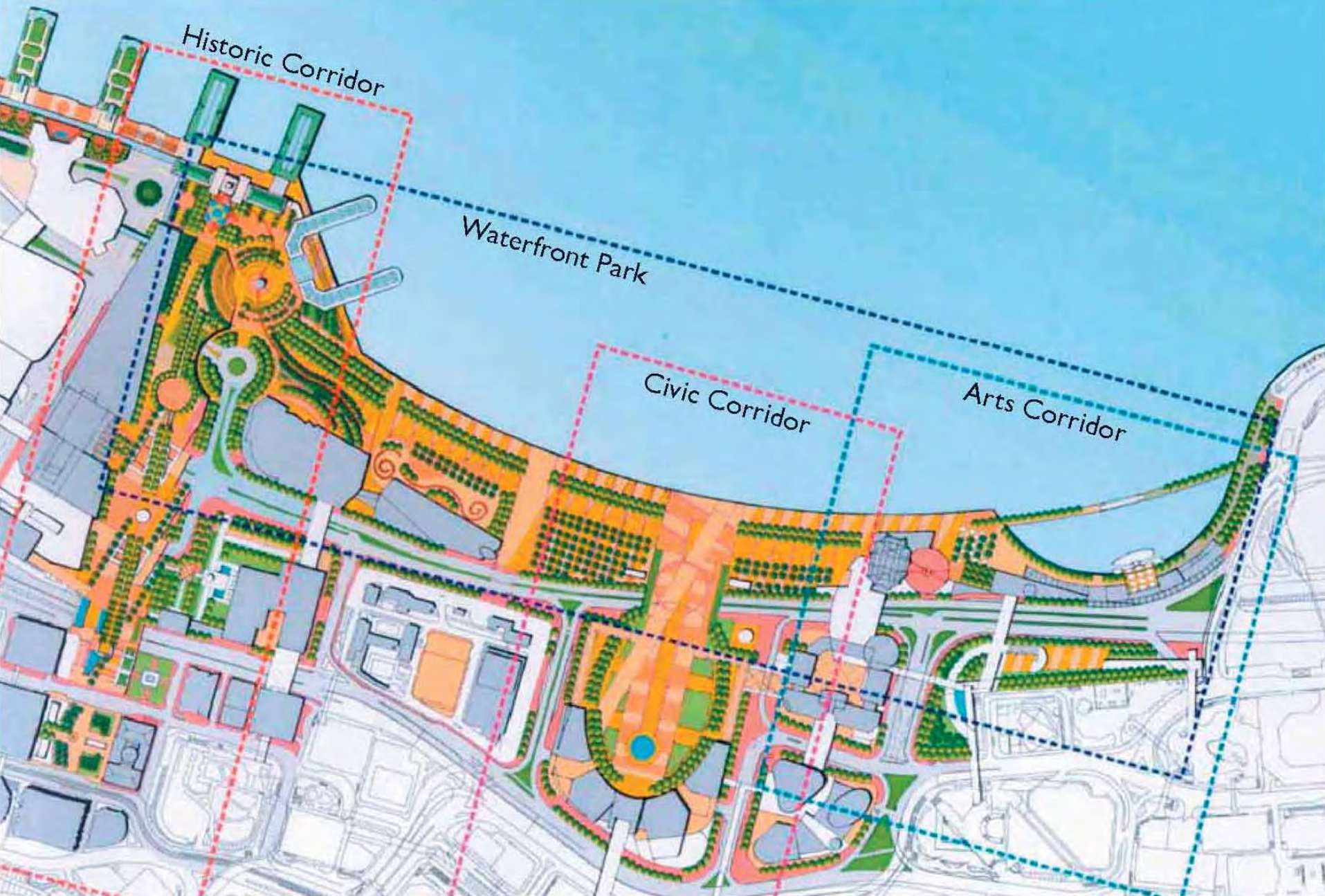



30 March 2006
Harbour Roundtable Luncheon Series III
Central Harbourfront Development

Why Business Interest in the Harbour?

- Business and Tourism Destination
- Quality Environment for a Healthy, Motivated and Creative Work Force
- Attract and Retain Talent – a Key Economic Driver
- Protect Value to Retain Business and Employment Opportunities
- Promotes the Image of Hong Kong
- Promote public spaces that are bustling with people to support a city bustling with business
- **Maintain Hong Kong's Regional Competitive Advantage**

An aerial photograph of Hong Kong, showing a dense urban landscape with numerous skyscrapers and a large body of water in the background. The image is framed by a white, wavy border at the top and bottom.

Coalition of Diverse Businesses

Hong Kong's Best Long-Term

- Economic
- Social
- Environmental Interests

- Public Opinion Survey
- Harbour-front Land use and Ownership Audit
- International Best Practice and Institutional Arrangements
- Value Study of Harbour
- “My Harbour” Design Competition
- Waterfront Development Forum
- Harbour Walk
- “Creating Valuable Cities” Conference

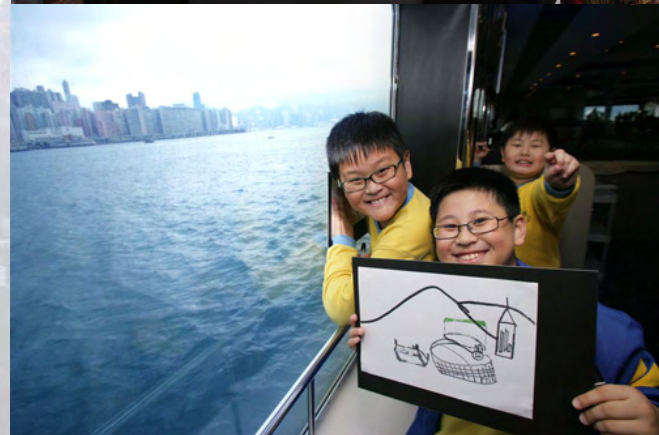



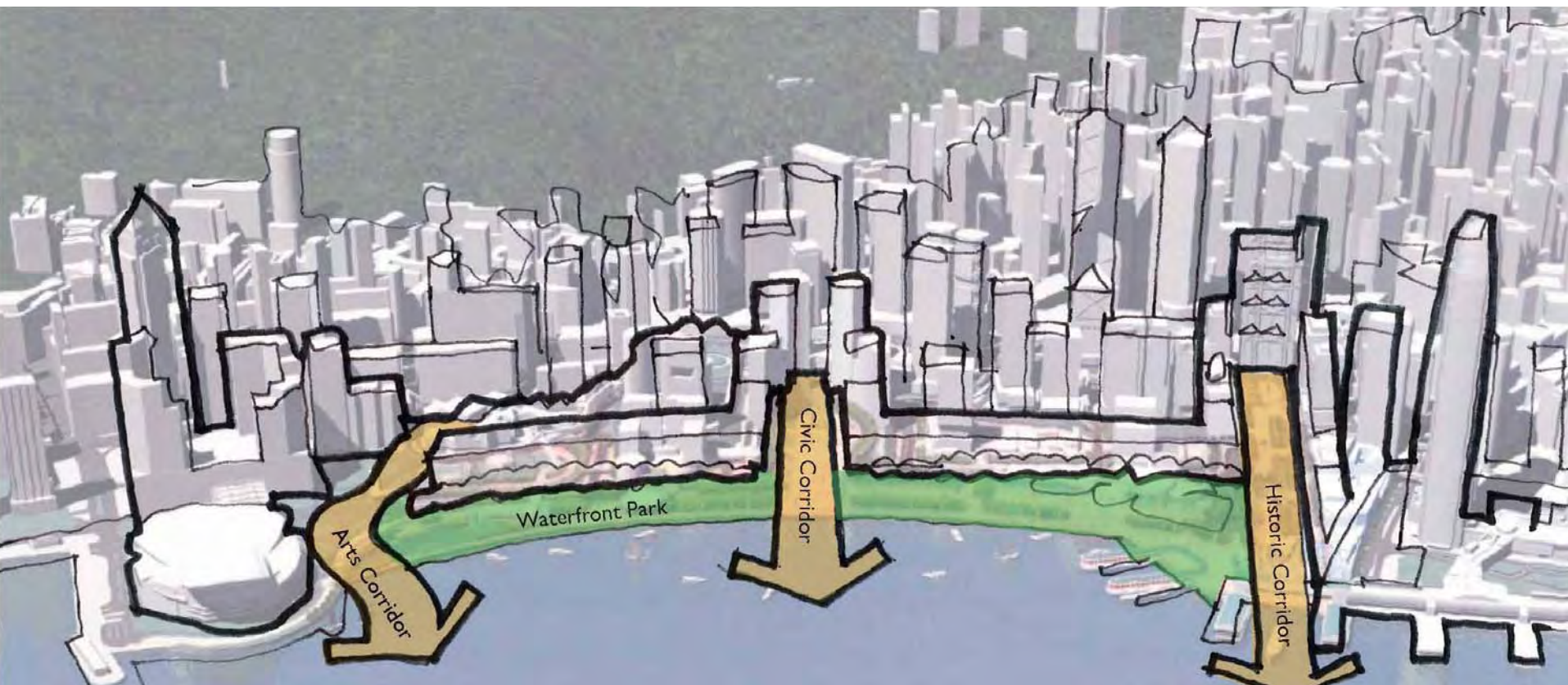

Government Plans for Central – Four Urban Concepts

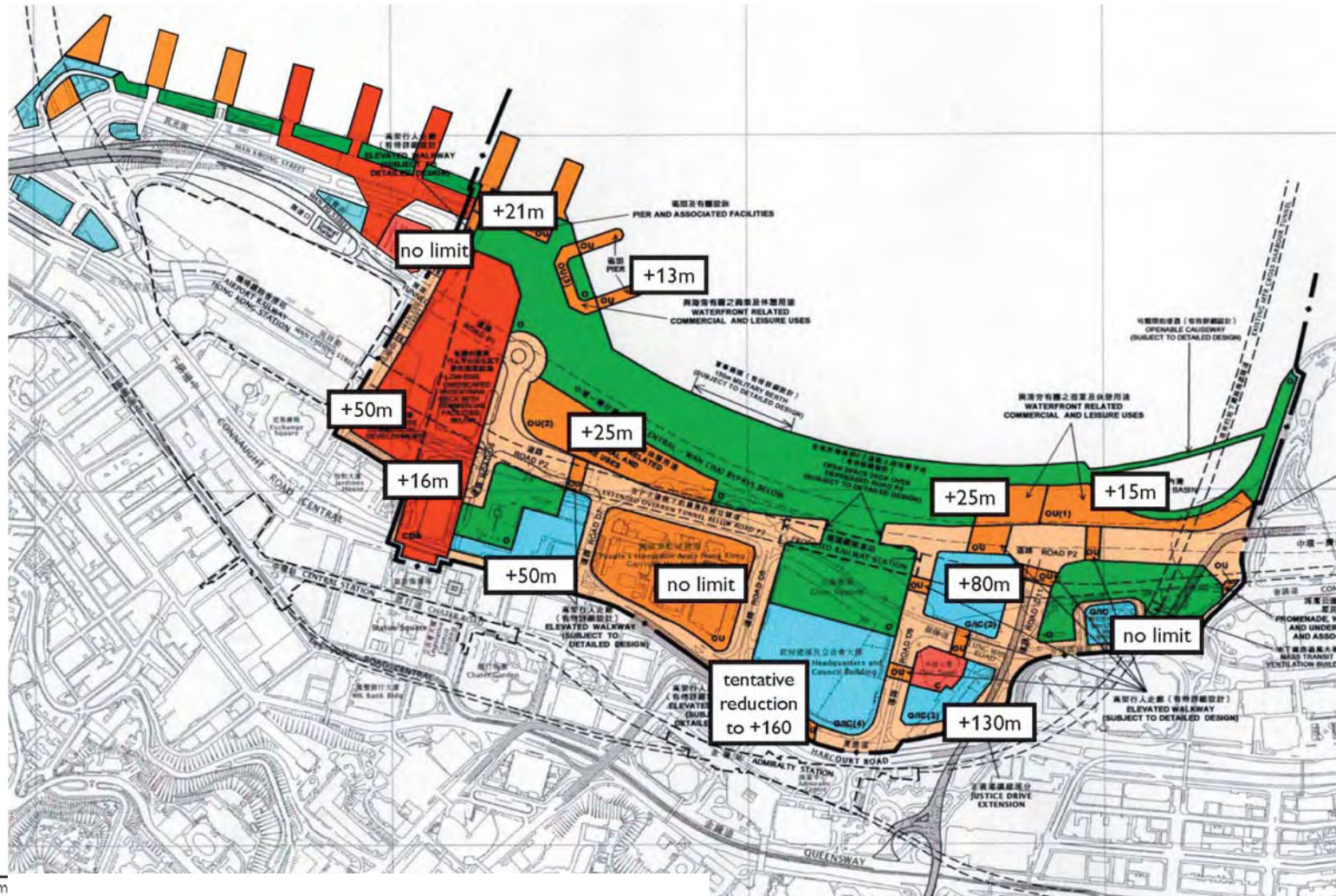

The Current OZP Provides Minimal Guidance for Urban Design

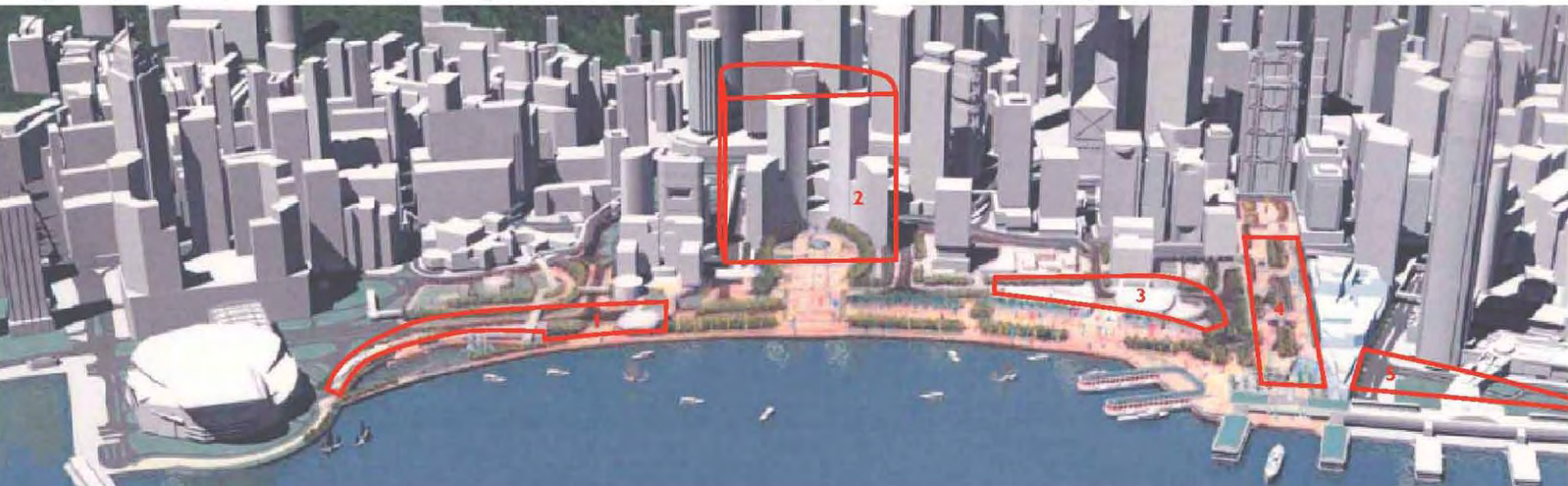
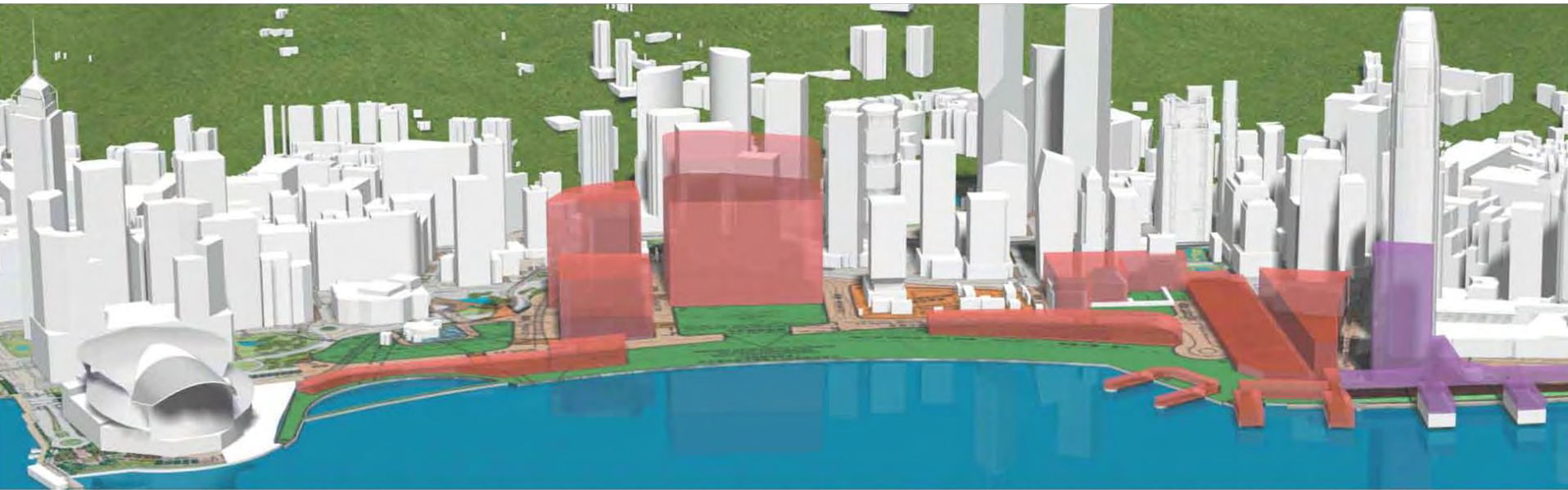

Harbour Planning Vision
Victoria Harbour: A harbour for the people, a harbour of life.

Harbour Planning Mission
To transform Victoria Harbour and its harbour-front areas into: an attractive, vibrant, accessible and sustainable world-class asset.

Harbour Planning Principles

The Harbour Planning Principles are a set of guidelines for all individuals and organisations in the sustainable planning, development and management of Victoria Harbour and the harbour-front areas. The principles are developed and monitored by the Harbour-front Enhancement Committee. The principles are dynamic and may be changed to meet future aspirations of the people of Hong Kong.

Sub-committee on Harbour Plan Review
Harbour-front Enhancement Committee
March 2005

1

Preserving Victoria Harbour as a Natural, Public and Economic Asset

Principle 1: Victoria Harbour must be preserved for Hong Kong people and visitors as a special public asset, a natural and cultural heritage, and a driver for the economy.

2

Victoria Harbour as Hong Kong's Identity

Principle 2: Planning, developing and managing Victoria Harbour must enhance the harbour and harbour-front areas as Hong Kong's symbol of urban design excellence and Hong Kong's "brand identity" to the international community.

3

A Vibrant Harbour

Principle 3: Balancing the harbour as a maritime and logistics hub for the safe and efficient passage of people and goods, with the harbour as a culture and leisure facility catering to the aspirations of all sectors of the community, requires diverse, attractive and vibrant harbour-front areas and a multitude of commercial, public, tourist, leisure, sports, culture, infrastructure and marine facilities.

4

An Accessible Harbour

Principle 4: Victoria Harbour must integrate with the hinterland in a comprehensive manner, including ample unrestricted and convenient visual and physical access to and along it as well as around the harbour-front areas.

5

Maximizing Harbour-front for Public Enjoyment

Principle 5: With limited land available around Victoria Harbour, land required for transport infrastructure, utilities and uses incompatible with these planning principles should be minimized.

6

Integrated Planning for a World-class Harbour

Principle 6: Integrated and long-term planning, development and management of infrastructure, land and marine uses, and water quality is required to ensure that Victoria Harbour and its harbour-front areas support Hong Kong's economic pillars and the aspirations of Hong Kong's people.

7

Sustainable Development of the Harbour

Principle 7: The planning, development and management of Victoria Harbour and its harbour-front areas should embrace the principles of sustainable development, i.e. balancing and catering to the economic, social and environmental needs of all sectors of the present generation, without compromising the needs of future generations.

8

Early and Ongoing Stakeholder Engagement

Principle 8: All sectors of the community must be engaged in the planning, development and management of Victoria Harbour and the harbour-front areas, through comprehensive consensus building processes involving relevant institutions.

1

Preserving Victoria Harbour as a Natural, Public and Economic Asset

Victoria Harbour must be preserved for Hong Kong people and visitors as a special public asset, a natural and cultural heritage, and a driver for the economy.

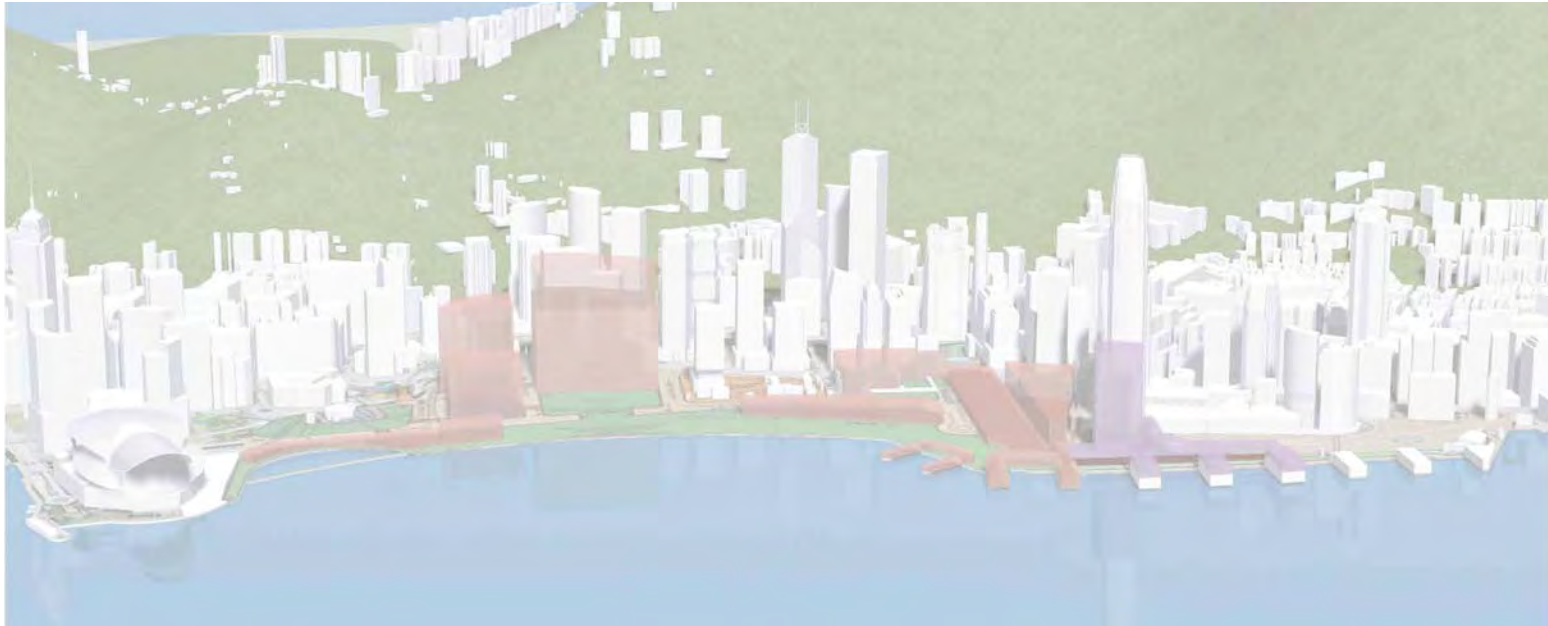

2

Victoria Harbour as Hong Kong's Identity

Planning, developing and managing Victoria Harbour must enhance the harbour and harbour-front areas as Hong Kong's symbol of urban design excellence and Hong Kong's "brand identity" to the international community.

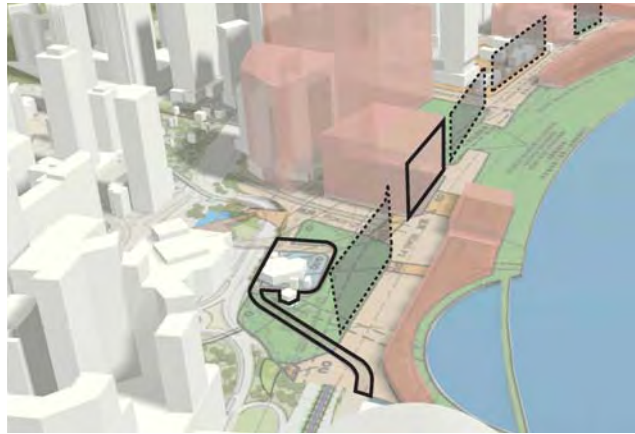
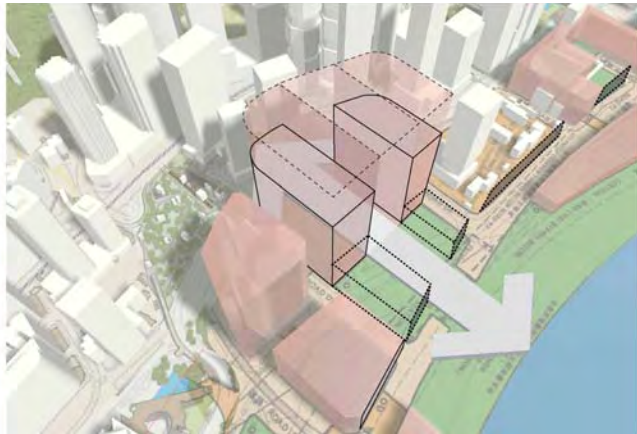
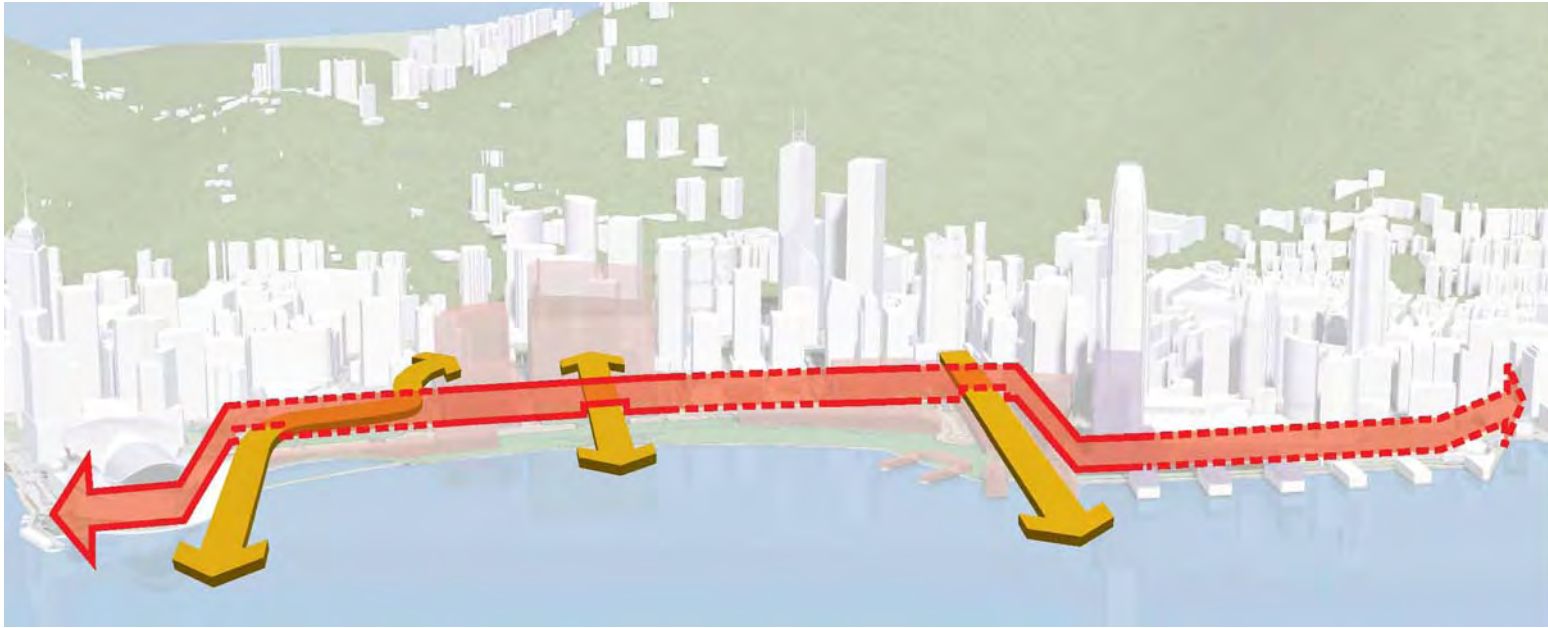

3

A Vibrant Harbour

Balancing the harbour as a maritime and logistics hub for the safe and efficient passage of people and goods, with the harbour as a culture and leisure facility catering to the aspirations of all sectors of the community, requires diverse, attractive and vibrant harbour-front areas and a multitude of commercial, public, tourist, leisure, sports, culture, infrastructure and marine facilities.



4

An Accessible Harbour

Victoria Harbour must integrate with the hinterland in a comprehensive manner, including ample unrestricted and convenient visual and physical access to and along it as well as around the harbour-front areas.

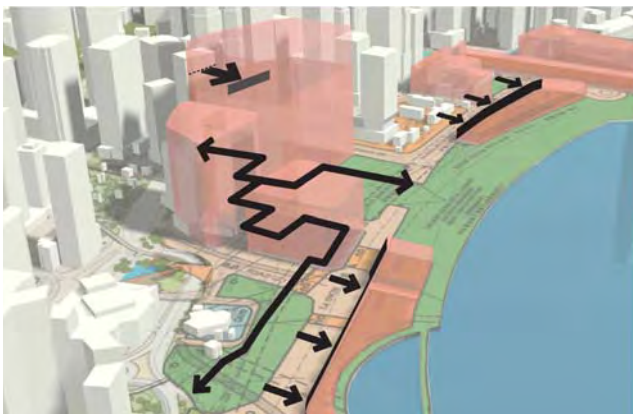
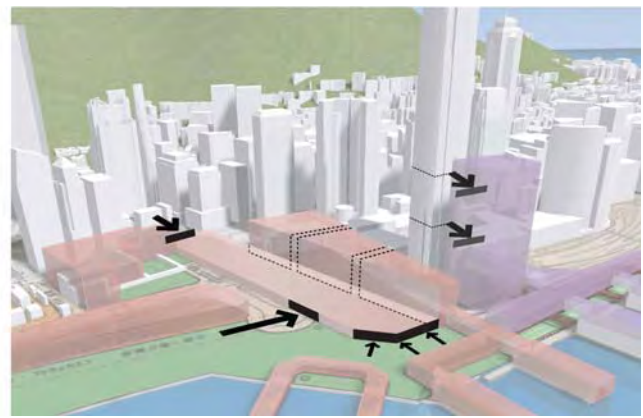
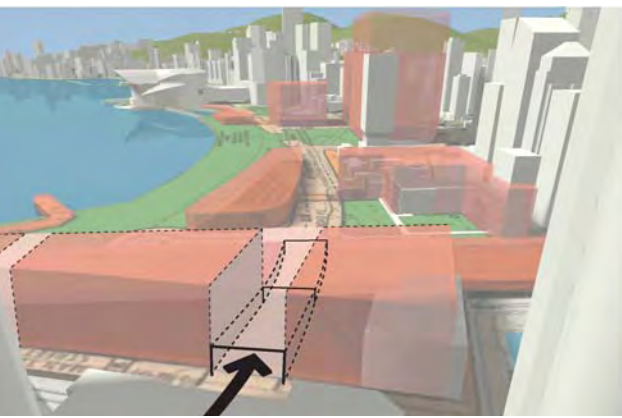
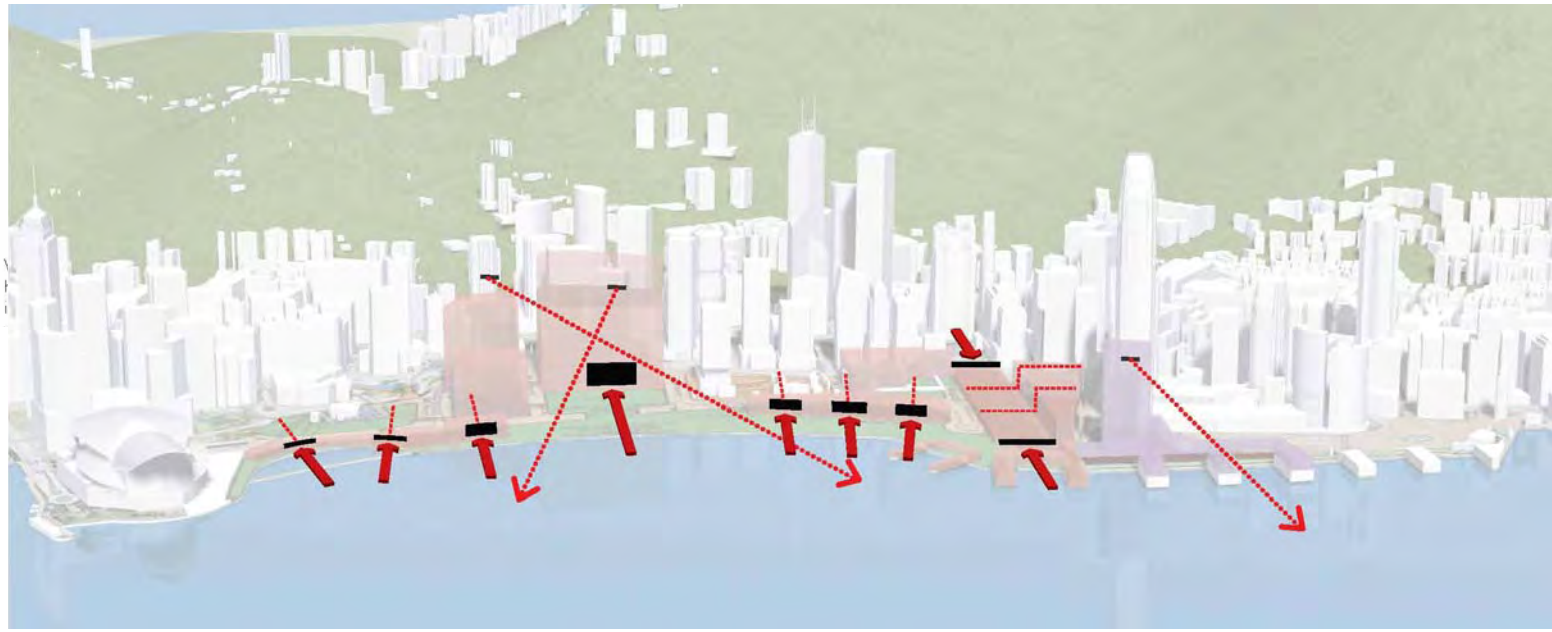

5

Maximizing Harbour-front for Public Enjoyment

With limited land available around Victoria Harbour, land required for transport infrastructure, utilities and uses incompatible with these planning principles should be minimized.

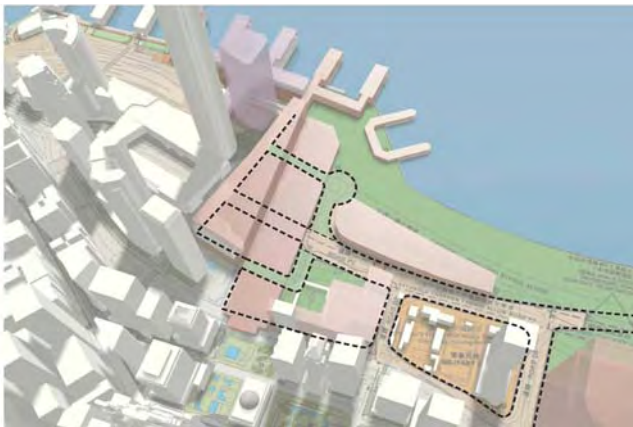
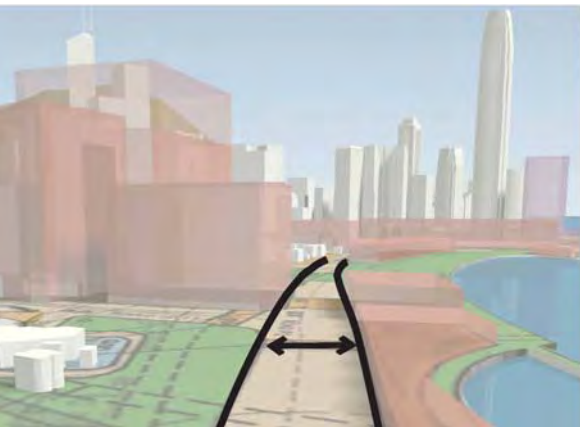
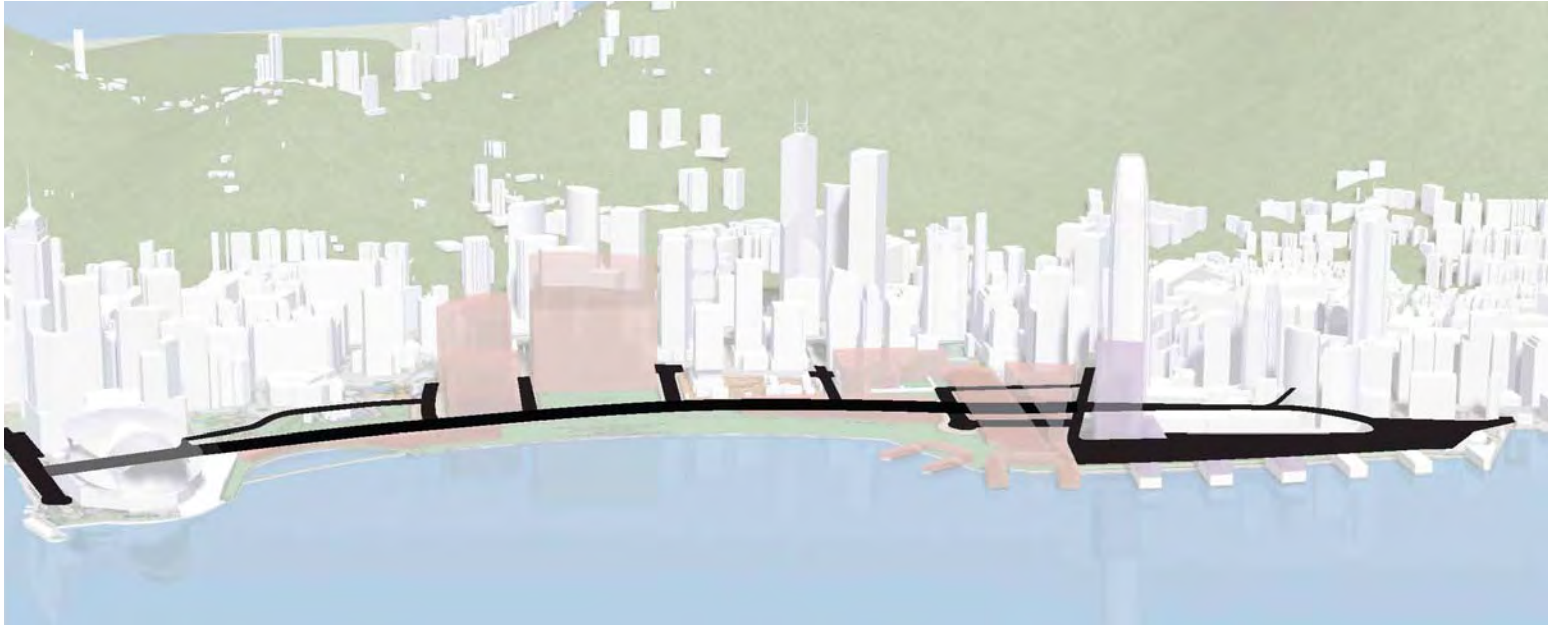

6

Integrated Planning for a World-class Harbour

Integrated and long-term planning, development and management of infrastructure, land and marine uses, and water quality is required to ensure that Victoria Harbour and its harbour-front areas support Hong Kong's economic pillars and the aspirations of Hong Kong's people.

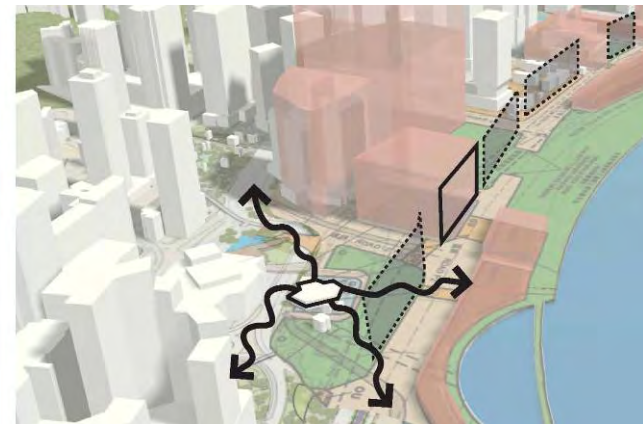

7

Sustainable Development of the Harbour

The planning, development and management of Victoria Harbour and its harbour-front areas should embrace the principles of sustainable development, i.e. balancing and catering to the economic, social and environmental needs of all sectors of the present generation, without compromising the needs of future generations

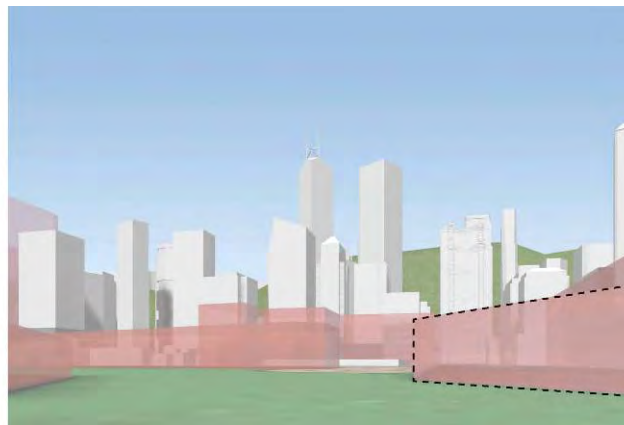
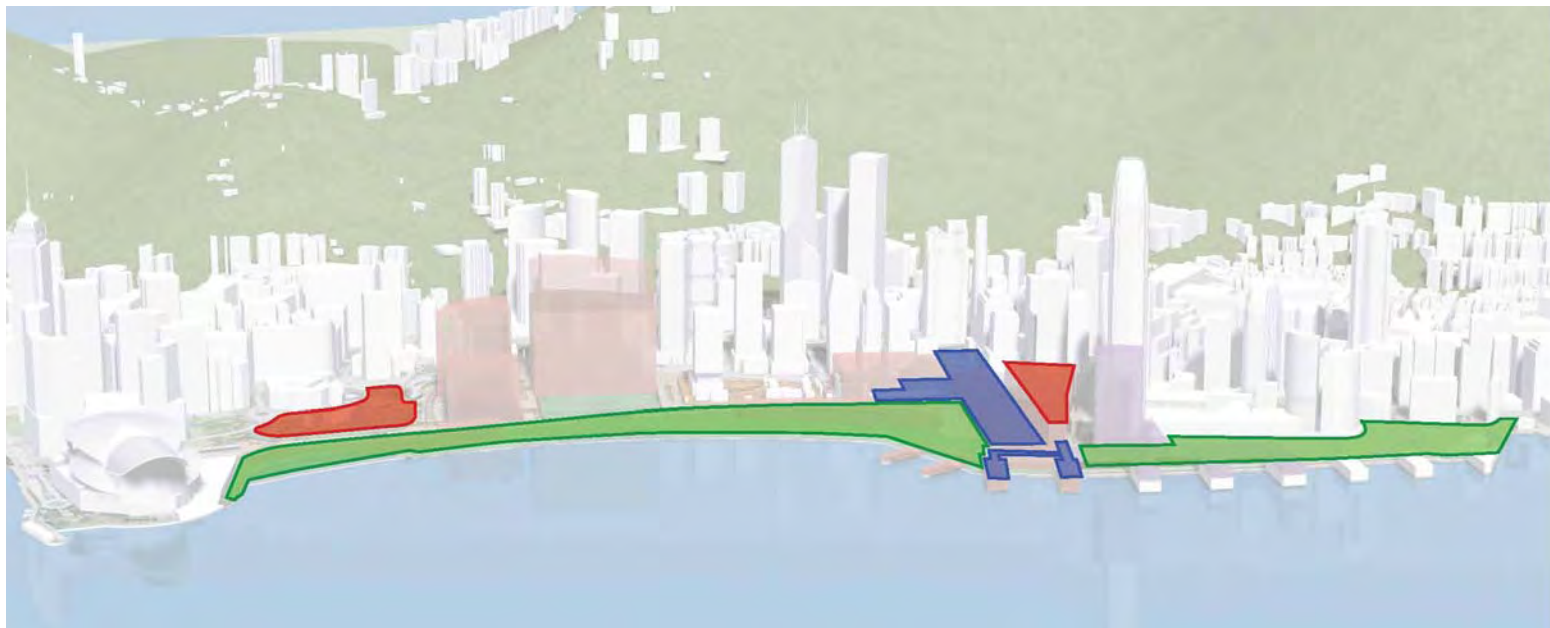

8

Early and Ongoing Stakeholder Engagement

All sectors of the community must be engaged in the planning, development and management of Victoria Harbour and the harbour-front areas, through comprehensive consensus building processes involving relevant institutions.

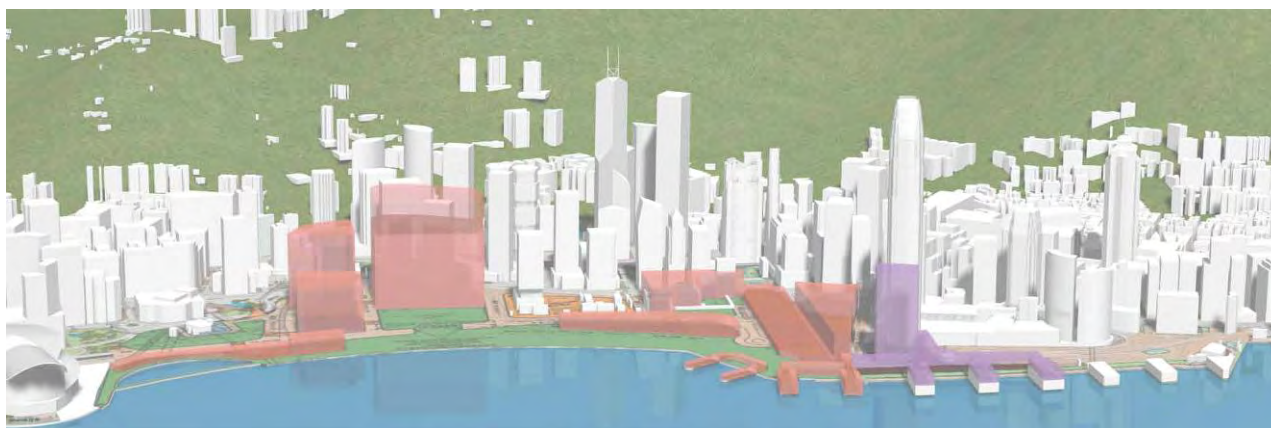
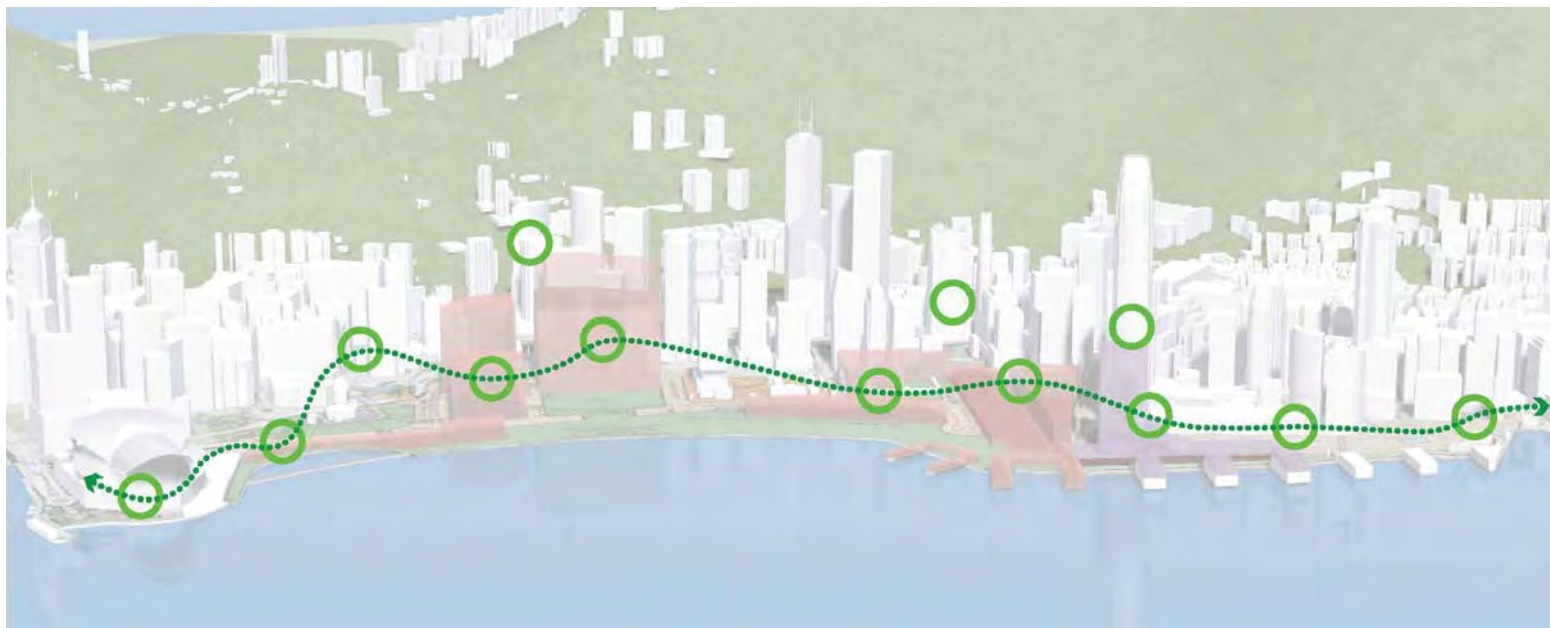

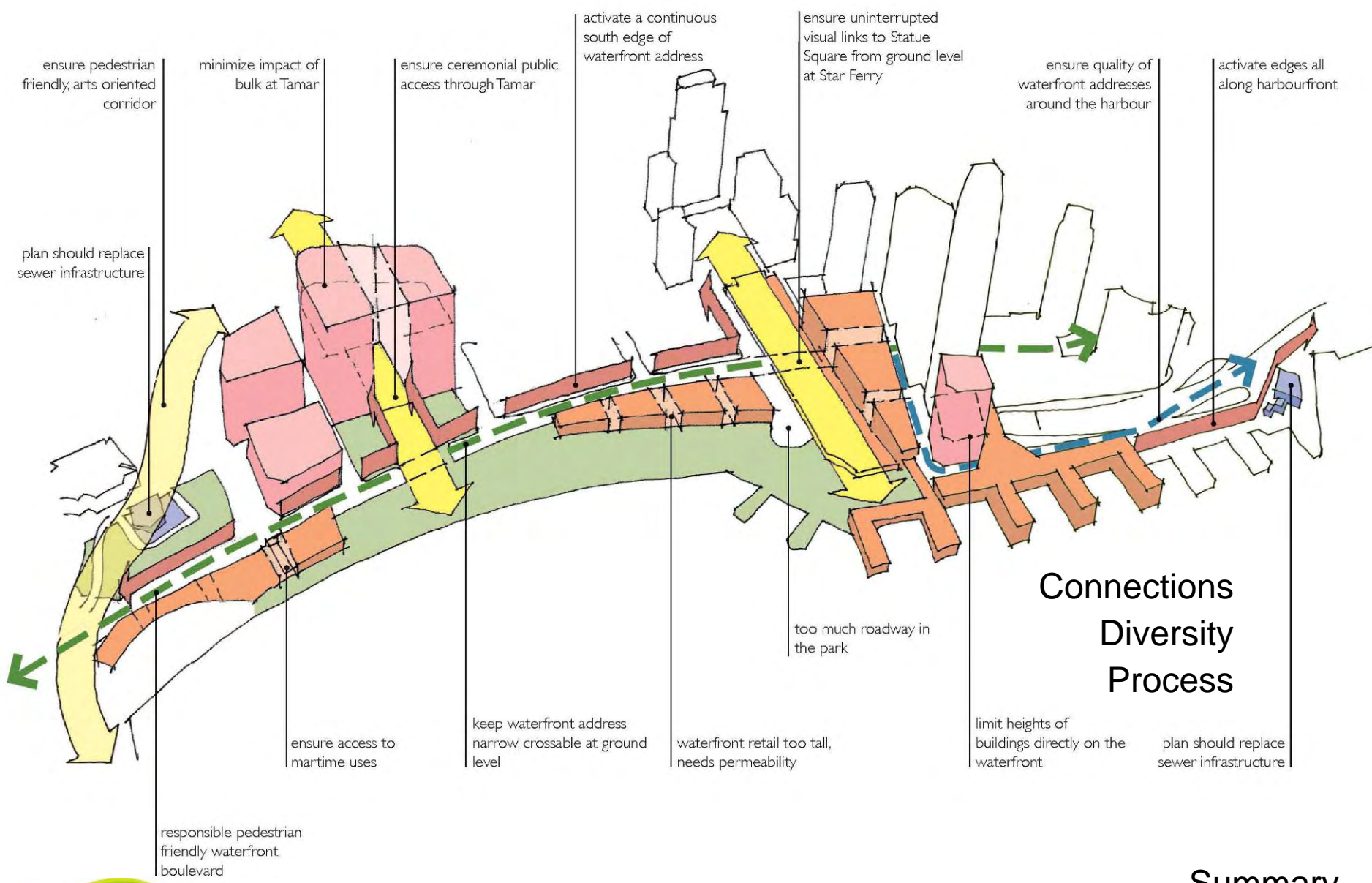

Connections Diversity Process

Summary

